



C A T A L O G U E



uPVC, SOIL, WASTE & VENT FITTINGS &  
UNDERGROUND DRAINAGE & SEWER SYSTEM



# Our Background



## YOUR SATISFACTION IS OUR COMMITMENT

Established in 1992, we are the manufacturer of "EXACT" brand of uPVC Soil, Waste and Vent Fittings (S.W.V.) in Malaysia. The company has contributed significantly towards national development by supplying high quality fittings specifically in water supply and drainage system for construction and infrastructure projects. EXACT products are manufactured with stringent quality control. Our effort to continuously improve on quality and reliability over the years has been rewarded with the accreditation of ISO 9001 certification since July 2000. Our products are also certified to the relevant Malaysian and British standards by SIRIM, the Malaysian standards authority. With the SIRIM certification and Ikram approval, Malaysian local authorities have approved the use of our products in projects under their jurisdiction.



# Achievement of ISO 9001



MS ISO 9001 REG. NO. AR2032

## The objective

- To understand the needs requirements of its customers.
- To maintain a high standard of quality for its products and services.
- To ensure total customer satisfaction.

## The Quality Policy

We are committed to comply with ISO 9001:2008 requirements and to enhance our customers' satisfaction through continuous improvement on product quality, JIT delivery and competitive pricing.



1. uPVC waste applications  
MS 1063 : 2002 Application area code : B  
(BS 5255 : 1989)
2. uPVC soil and vent applications  
MS 1063 : 2002 Application area code : B  
(BS 4514 : 1983)
3. uPVC underground drainage applications  
MS 1063 : 2002 Application area code : D

4. Quality Management Systems  
ISO 9001 : 2008
5. IKRAM listing
6. Official approval from Malaysia local authorities





Our range of uPVC S.W.V. products are designed to provide an economical, complete and efficient system of plumbing for both domestic and industrial sanitary applications.

**EXACT** range of uPVC S.W.V. Fitting utilise Unplasticised PVC materials which provide the following advantages :

- Easy and economical installation
- Outstanding chemical resistance
- Non-flammability
- Weather resistance
- High flow rate

**EXACT** range of uPVC S.W.V. Fittings are manufactured by injection moulding, employing precision moulds and techniques to ensure a high standard of finished product quality, consistency and ultimately, reliability. Manufactured to comply with British Standards 4514 & 5255 Malaysian Standards 1063 : 2002.

## MANUFACTURING CONTROL FLOW CHART

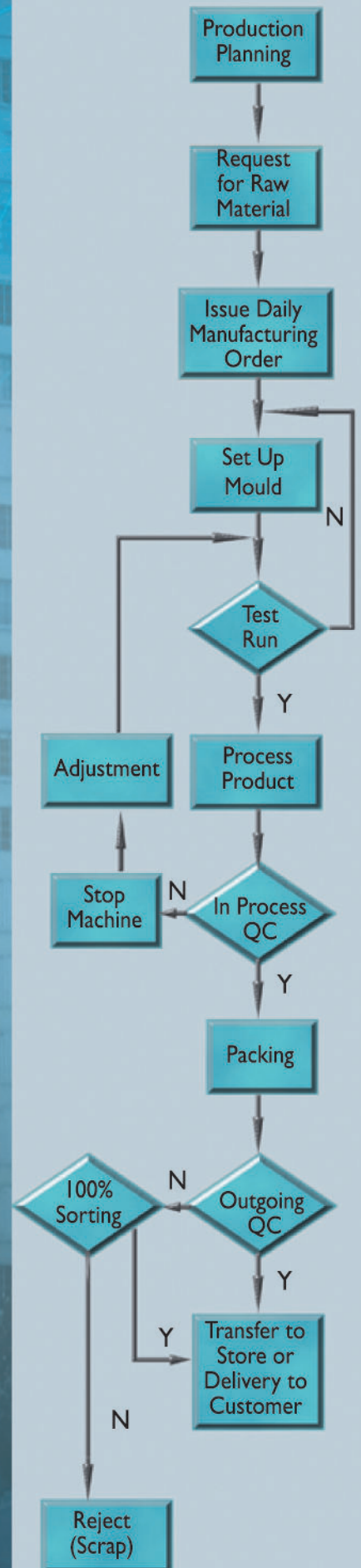

## Typical soil, waste and vent piping layout for 2 storey house using EXACT SWV pipes & fittings

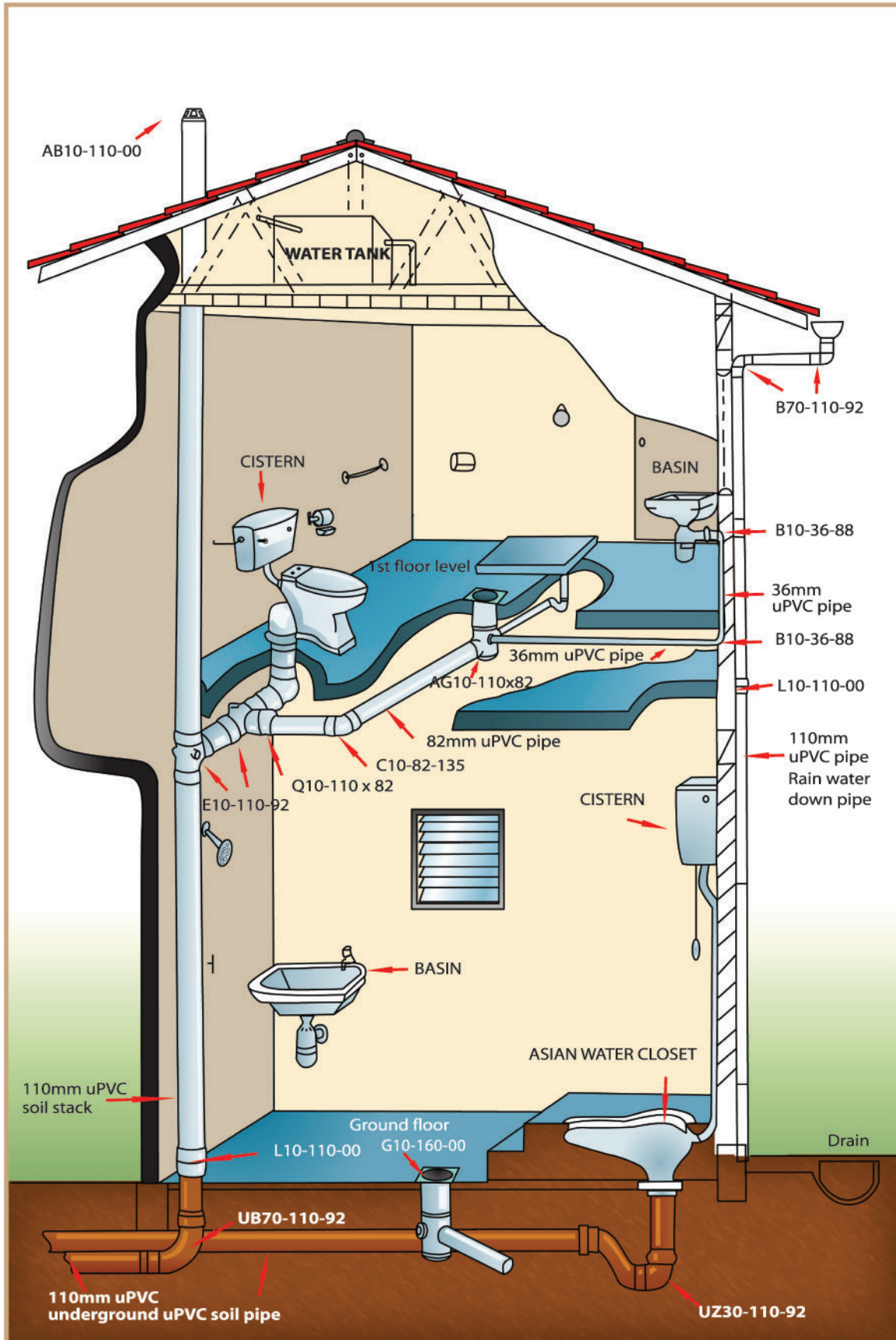



# PRODUCT CODE

**AB 99 – 999 – 99**

## Prefix

AB – Abbreviation for Product Name

99 – Series Code

## Nominal Size

Nominal Size in millimeter  
(eg. "110" for 110mm)

## Nominal Angle

Nominal Angle (eg. "88" for 88°)

## Sample

**E10 – 43 – 88**

Equal Single Branch with Nominal Size of 43mm and Nominal Angle of 88°.

**PS10 – 110 – 00**

Pipe Sleeve with Nominal Size of 110mm and Nominal Angle of 0°.

**C10 – 56 – 45**

Bend with Nominal Size of 56mm and Nominal Angle of 45°.

# EXACT

## uPVC, Soil, Waste, Vent Fittings

### Sweep Bend

Code No.	Size (mm)	Angle $\theta$	D1	L1
B10-36-88	36	91.25	36.3	20
B10-43-88	43	91.25	42.9	25
B10-56-88	56	91.25	55.9	28
B70-82-92	82	92.5	82.6	45
B70-110-92	110	92.5	110.2	50
B10-160-92	160	92.5	160.4	78
B10-200-92	200	92.5	200.5	80

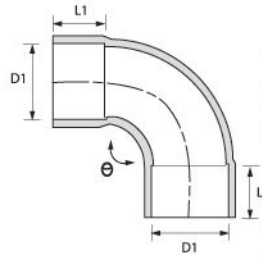

To solvent weld to pipe or fitting

### Sweep Bend with I/O

Code No.	Size (mm)	Angle $\theta$	D1	L1
B20-43-88	43	91.25	42.9	21.5
B20-56-88	56	91.25	55.9	28
B20-82-92	82	92.5	82.6	45
B20-110-92	110	92.5	110.2	50
B20-160-92	160	92.5	160.4	78

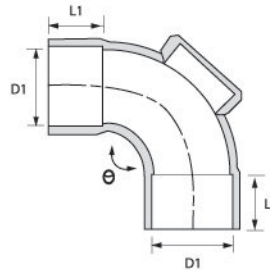

To solvent weld to pipe or fitting fitted with inspection opening.

### 45° Bend Plain

Code No.	Size (mm)	Angle $\theta$	D1	L1
C10-36-45	36	45	36.3	24
C10-43-45	43	45	42.9	25
C10-56-45	56	45	55.9	28
C10-82-135	82	45	82.6	45
C10-110-135	110	45	110.2	50
C10-160-135	160	45	160.4	78
C10-200-135	200	45	200.5	80

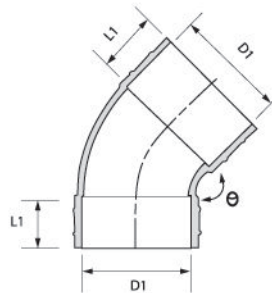

To solvent weld to pipe.

### Floor Gully Trap I/O

Code No.	Size (mm)	D1	D2	D3	D4	H
AG10-110x56	110 x 56	110.2	55.9	55.9	42.9	212
AG10-110x82	110 x 82	110.2	82.6	55.9	42.9	212

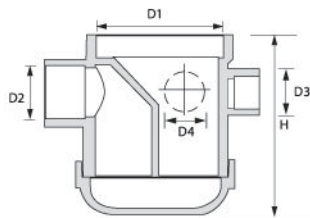

Integrally moulded boss adaptor with 40mm & 50mm socket to accept waste pipe or other fittings.

# EXACT

## uPVC, Soil, Waste, Vent Fittings

### Equal Single Branch

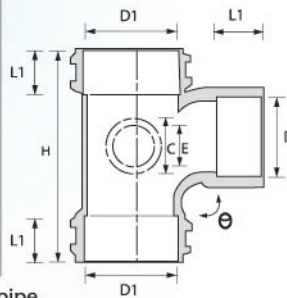

To solvent weld to soil pipe. 92 branches have integrally moulded boss adaptor socket to accept waste pipe or fitting.

Code No.	Size (mm)	Angle $\theta$	D1	L1	H	C	E
E10-36-88	36	91.25	36.3	24	89	-	-
E10-43-88	43	91.25	42.9	25	109	-	-
E10-56-88	56	91.25	55.9	28	135	-	-
E10-82-92	82	92.5	82.6	45	205	-	42.9
E10-110-92	110	92.5	110.2	50	250	-	55.9
E10-160-92	160	92.5	160.4	75	350.5	82.6	55.9
E10-200-92	200	90.0	200.5	80	404	82.6	55.9

### Equal Single Branch with I/O

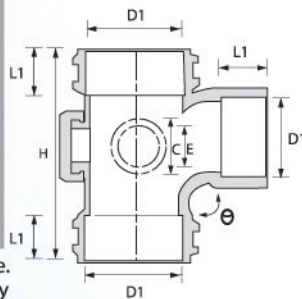

To solvent weld to soil pipe. 92 branches have integrally moulded boss adaptor socket to accept waste pipe or fitting with inspection opening.

Code No.	Size (mm)	Angle $\theta$	D1	L1	H	C	E
E20-43-88	43	91.25	42.9	25	110	-	-
E20-56-88	56	91.25	55.9	28	135	-	-
E20-82-92	82	92.5	82.6	45	205	-	42.9
E20-110-92	110	92.5	110.2	50	250	-	55.9
E20-160-92	160	92.25	160.4	75	350.5	82.6	55.9

### Reducing Equal Single Branch

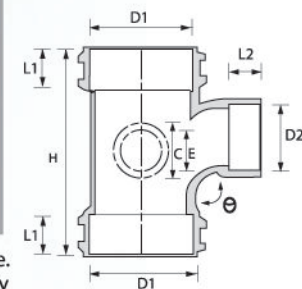

To solvent weld to soil pipe. 92 branches have integrally moulded boss adaptor socket to accept waste pipe or fitting.

Code No.	Size (mm)	Angle $\theta$	D1	D2	L1	L2	H	C	E
E10-160x110	160x110	92.5	160.4	110.2	75	50	310	-	55.9

### Reducing Equal Single Branch with I/O

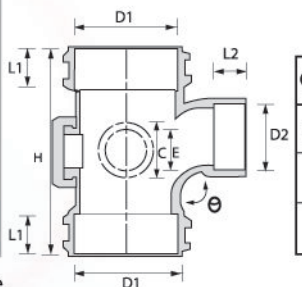

To solvent weld to soil pipe. 92 branches have integrally moulded boss adaptor socket to accept waste pipe or fitting with inspection opening.

Code No.	Size (mm)	Angle $\theta$	D1	D2	L1	L2	H	C	E
E20-160x110	160x110	92.5	160.4	110.2	75	50	310	-	55.9



# EXACT

## uPVC, Soil, Waste, Vent Fittings

### Straight Coupler

Code No.	Size (mm)	D1	L1
L10-36-00	36	36.3	24
L10-43-00	43	42.9	25
L10-56-00	56	55.9	28
L10-82-00	82	82.6	45
L10-110-00	110	110.2	50
L10-160-00	160	160.4	78
L10-200-00	200	200.5	80

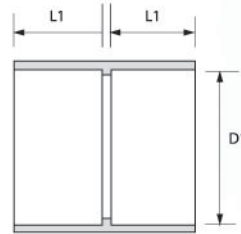

To solvent weld together two length of uPVC soil or waste pipes.

### Straight Coupler(Plain)

Code No.	Size (mm)	D1	L1
L30-110-00	110	110.2	50

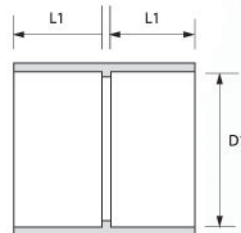

To solvent weld together two length of uPVC soil or waste pipes.

### Pipe Sleeve

Code No.	Size (mm)	D1	H
PS10-56-00	56	55.9	110
PS10-82-00	82	82.6	110
PS10-110-00	110	110.2	110
PS10-160-00	160	160.4	161
PS10-200-00	200	200.5	175

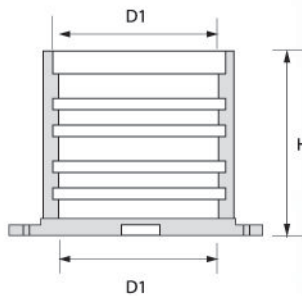

Fpr cast into RC floor slab/ concrete wall to provide a through socket for pipes.

### Pipe Sleeve

Code No.	Size (mm)	D1	H
PS30-160-00	160	160.4	110.1

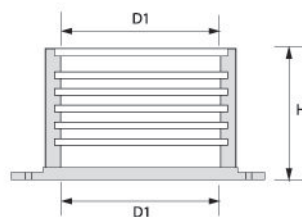

Fpr cast into RC floor slab/ concrete wall to provide a through socket for pipes.

# EXACT

## uPVC, Soil, Waste, Vent Fittings

### Bush / Socket Reducer

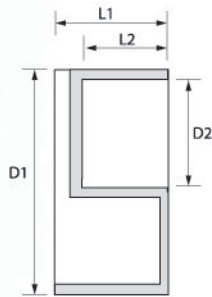

To allow for change in fittings socket diameter.

Code No.	Size (mm)	D1	D2	L1	L2
Q10-43x36	43 x 36	42.9	36.3	22	19
Q10-56x36	56 x 36	55.9	36.3	28	19
Q10-56x43	56 x 43	55.9	42.9	28	22
Q10-82x56	82 x 56	82.6	55.9	45	28
Q10-110x56	110 x 56	110.2	55.9	50	28
Q10-110x82	110 x 82	110.2	82.6	50	45
Q10-160x110	160 x 110	160.4	110.2	78	50
Q10-200x160	200 x 160	200.5	160.4	80	81

### Reducing Socket

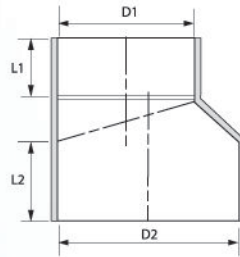

To allow for change in pipe diameter with larger end spigot to fitting and other end socket to pipe.

Code No.	Size (mm)	D1	D2	L1	L2
Q30-110x82	110x82	82.6	110.2	46.5	53

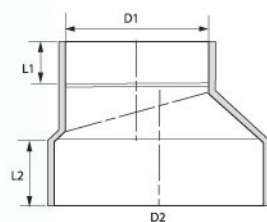

To allow for change in pipe diameter with larger end spigot to fitting and other end socket to pipe.

Code No.	Size (mm)	D1	D2	L1	L2
Q30-160x110	160x110	110.2	160.4	48	51.5

### End Cap

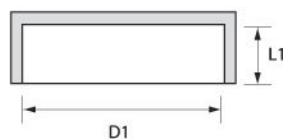

To cover up the open-end of a pipe line for later accessibility

Code No.	Size (mm)	D1	L1
EC10-56-00	56	55.9	31
EC10-82-00	82	82.6	31
EC10-110-00	110	110.2	25
EC10-160-00	160	160.4	75



# EXACT

## uPVC, Soil, Waste, Vent Fittings

### Boss Connector

Code No.	Size (mm)	D1	D2	L
Y20-82x56	82 x 56	82.6	55.9	28
Y20-160x82	160 x 82	160.4	82.6	45
Y20-160x110	160 x 110	160.4	110.2	50
Y30-110x56	110 x 56	110.2	55.9	28
Y30-110x82	110 x 82	110.2	82.6	45

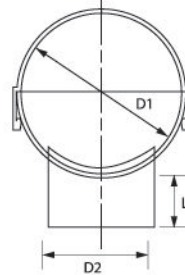

To connect waste pipe to soil pipe and for venting by solvent cement. Incorporates a bracket specially designed to hold boss connector firmly in place during installation.

### Pipe Holder

Code No.	Size (mm)	D1	L1	W1
PH10-110-00	110	110.4	28.7	3.0

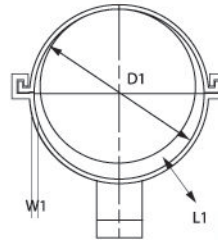

### PT Socket

Code No.	Size (mm)	D1	D2	L1	L2
PT10-36-00	36	36	42	33.5	24
PT10-43-00	43	43	48	39	28.5

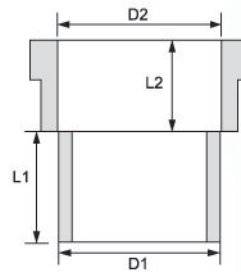

To Connect basin joint directly to PVC pipe

### PT Elbow

Code No.	Size (mm)	Angle $\theta$	D1	D2	L1	L2	W1
PE10-36-00	36	92.5°	34	40	33.5	24	2.2
PE10-43-00	43	92.5°	42	47	39	28.5	2.6

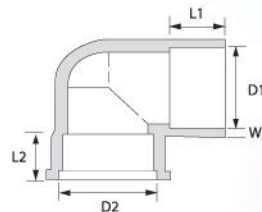

# EXACT

## uPVC, Soil, Waste, Vent Fittings

### "P" trap Plain

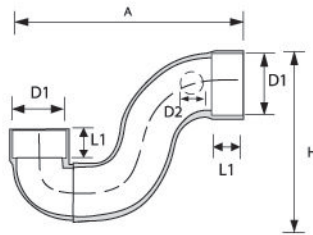

Code No.	Size (mm)	D1	D2	L1	A	H
Z30-110-92	110	110.2	55.9	50	380	270

"P" Trap with water seal for gas-tight connection to SWV system.

### "P" Trap Plain ( U body )

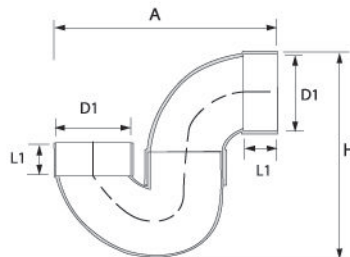

Code No.	Size (mm)	D1	L1	A	H
Z50-110-90	110	110.2	50	300	280

"P" Trap with water seal for gas-tight connection to SWV system.

### "P" trap with I/O

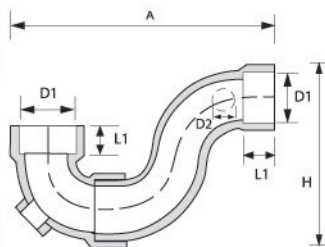

Code No.	Size (mm)	D1	D2	L1	A	H
Z10-56-88	56	55.9	55.9	28	240	180
Z10-110-92	110	110.2	55.9	50	380	270

"P" Trap with water seal for gas-tight connection to SWV system with inspection opening.

### "P" trap with I/O ( U body )

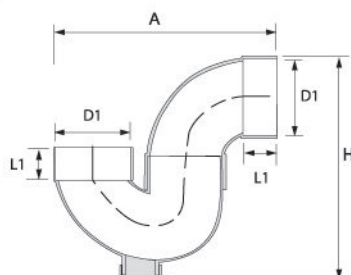

Code No.	Size (mm)	D1	D2	L1	A	H
Z60-110-90	110	110.2	55.9	50	300	290

"P" Trap with water seal for gas-tight connection to SWV system with inspection opening.



# EXACT

## uPVC, Soil, Waste, Vent Fittings

### "S" Trap Plain

Code No.	Size (mm)	D1	L1	A	H
S30-110-92	110	110.2	50	470	280

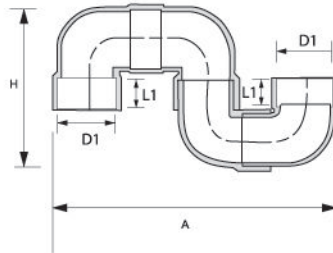

"S" Trap with water seal for gas-tight connection to SWV system.

### "S" Trap Plain ( U Body )

Code No.	Size (mm)	D1	L1	A	H
S50-110-90	110	110.2	50	390	260

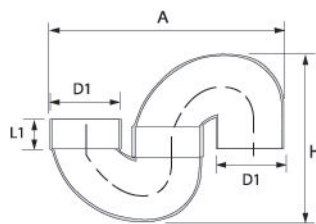

"S" Trap with water seal for gas-tight connection to SWV system.

### "S" Trap with I/O

Code No.	Size (mm)	D1	L1	A	H
S20-110-92	110	110.2	50	470	280

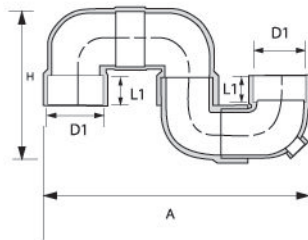

"S" Trap with water seal for gas-tight connection to SWV system with inspection opening.

### "S" Trap with I/O ( U Body )

Code No.	Size (mm)	D1	L1	A	H
S60-110-90	110	110.2	50	390	270

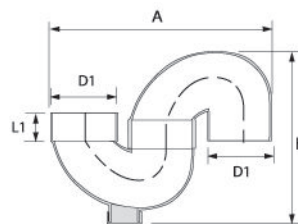

"S" Trap with water seal for gas-tight connection to SWV system.

### "S" Trap with I/O ( Offset )

Code No.	Size (mm)	D1	D2	L1	A	H
S20-110-OFF	110	110.2	55.9	48	495	270

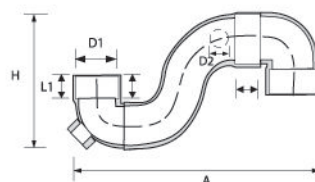

# EXACT

## uPVC, Soil, Waste, Vent Fittings

### Bossed Bend (M/F)

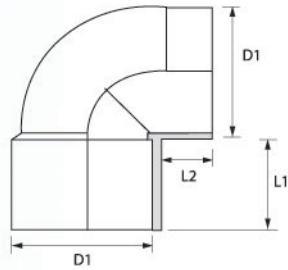

Code No.	Size (mm)	Angle $\theta$	D1	L1	L2
B50-110-90	110	90	110.2	50	25

### Bossed Bend with I/O (M/F)

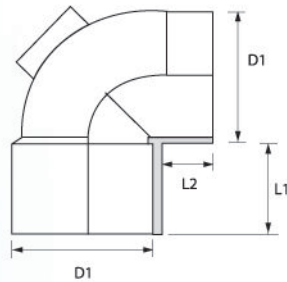

Code No.	Size (mm)	Angle $\theta$	D1	L1	L2
B60-110-90	110	90	110.2	50	25

### U Body with I/O (M/F)

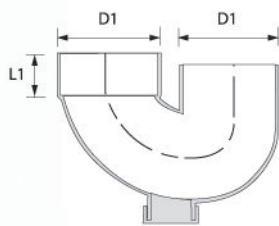

Code No.	Size (mm)	D1	L1
U20-110-90	110	110.2	50

### U Body (M/F)

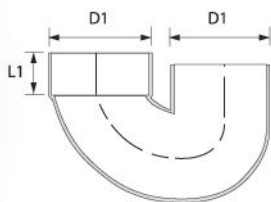

Code No.	Size (mm)	D1	L1
U10-110-90	110	110.2	50



# EXACT

## uPVC, Soil, Waste, Vent Fittings

### Vent Cowl

Code No.	Size (mm)	D1	L1
AB10-56-00	56	55.9	30
AB10-82-00	82	82.6	25
AB10-110-00	110	110.2	25.5

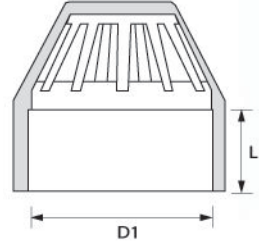

To cap open end of soil and vent stack, solvent welded to pipe.

### Dome Filter

Code No.	Size (mm)	D1	L1	W1
AB30-110-00	110	110.2	28.5	4
AB10-160-00	160	155	50	5

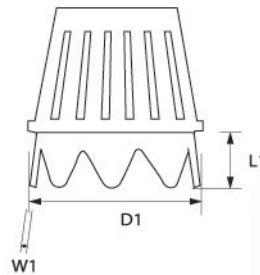

### Floor Gully with Trap & I/O (50mm)x3

Code No.	Size (mm)	D1	D2	D3	D4	H
AG30-110x56	110x56	110.2	55.9	55.9	55.9	194.2

### Floor Gully with Trap & I/O (82mmx50mm)

Code No.	Size (mm)	D1	D2	D3	D4	H
AG30-110x82	110x82	110.2	82.6	55.9	55.9	194.2

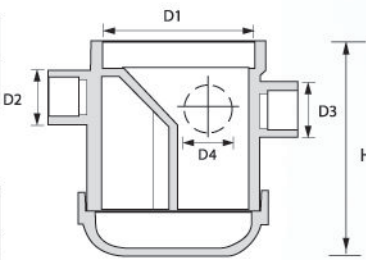

Integrally moulded boss adaptor with & 50mm socket to accept waste pipe or other fittings.

### Floor Grating

Code No.	L1	L2	D1	D2	W1	W2
G10-160-00	144	144	100.5	100	2.5	4.0

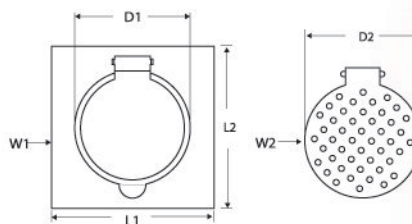

# EXACT

## Underground Drainage & Sewer System

### Underground Sweep Bend

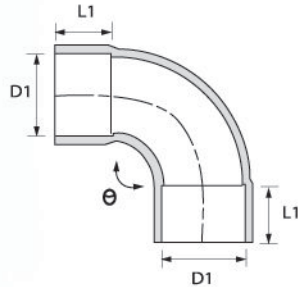

To solvent weld to soil pipe.

Code No.	Size (mm)	Angle $\theta$	D	L
UB70-110-92	110	92.5	110.2	50
UB10-160-92	160	92.5	160.4	78
UB10-200-92	200	92.5	200.5	80

### 45° Underground Bend Plain

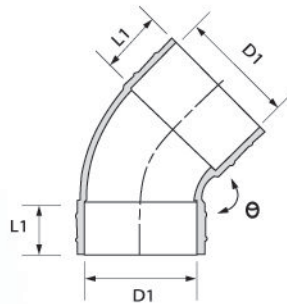

To solvent weld to soil pipe.

Code No.	Size (mm)	Angle $\theta$	D1	L1
UC10-110-135	110	45	110.2	50
UC10-160-135	160	45	160.4	78
UC10-200-135	200	45	200.5	80

### Underground Straight Coupling

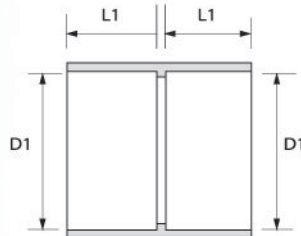

To solvent weld together two length of uPVC soil or waste pipes

Code No.	Size (mm)	D1	L1
UL10-110-00	110	110.2	50
UL10-160-00	160	160.4	78
UL10-200-00	200	200.5	80

### Underground Equal Single Branch

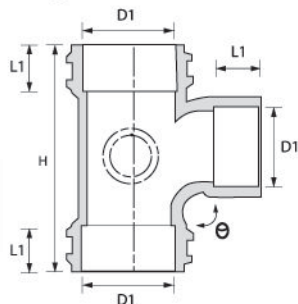

To solvent weld to soil pipe. 92 branches have integrally moulded boss adaptor socket to accept waste pipes or fitting.

Code No.	Size (mm)	Angle $\theta$	D1	L1	H
UE10-110-92	110	92.5	110.2	50	250
UE10-160-92	160	92.5	160.4	75	350.5
UE10-200-92	200	92.5	200.5	80	404



# EXACT

## Underground Drainage & Sewer System

### Underground "P" Trap Plain

Code No.	Size (mm)	D1	L1	A	H
UZ30-110-92	110	110.2	50	380	270

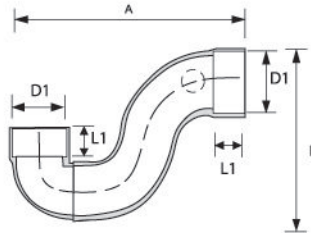

Underground "P" Trap with water seal for gas-tight connection to SWV system.

### Underground "P" Trap Plain ( U body )

Code No.	Size (mm)	D1	L1	A	H
UZ50-110-90	110	110.2	50	300	280

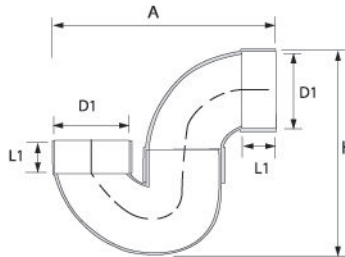

Underground "P" Trap with water seal for gas-tight connection to SWV system.

### Underground "S" Trap Plain

Code No.	Size (mm)	D1	L1	A	H
US30-110-92	110	110.2	50	470	280

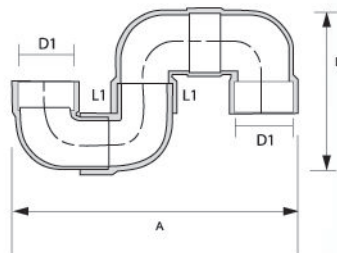

Underground "S" Trap with water seal for gas-tight connection to SWV system.

### Underground "S" Trap Plain ( U body )

Code No.	Size (mm)	D1	L1	A	H
US50-110-90	110	110.2	50	390	260

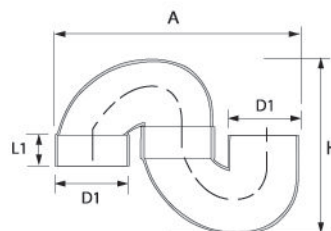

Underground "S" Trap with water seal for gas-tight connection to SWV system.

# EXACT

## Underground Drainage & Sewer System

### Underground Reducing Equal Single Branch

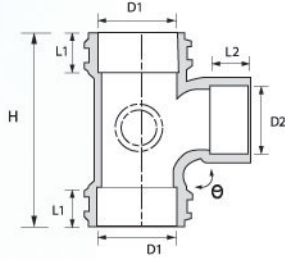

Code No.	Size (mm)	Angle $\theta$	D1	L1	D2	L2	H
UE10-160x110	160x110	92.5	160.4	75	110.2	50	350

### Underground Bossed Bend (M/F)

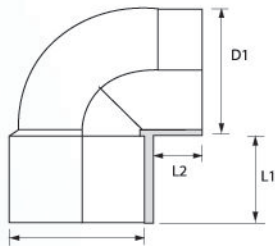

Code No.	Size (mm)	Angle $\theta$	D1	L1	L2
UB50-110-90	110	90	110.2	50	25

### Underground U Body (M/F)

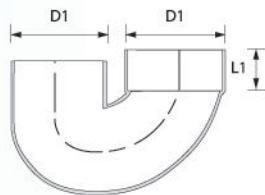

Code No.	Size (mm)	D1	L1
UU10-110-90	110	110.2	50



## Installation of Pipes and Fittings with Solvent Cement Jointing Procedure

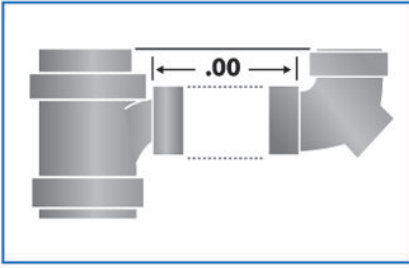

1. Measure pipe from bottom or shoulder of each socket into which pipe is to fit.

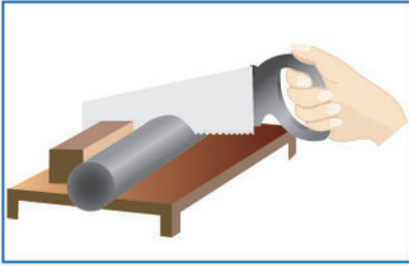

2. Cut pipe to required length, making sure cut is square.

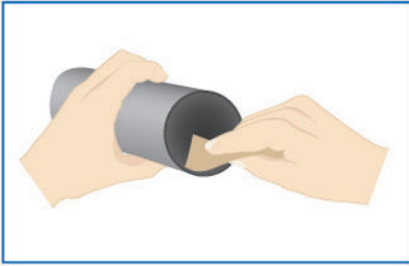

3. Ream inside and chamfer outside of pipe to eliminate all burrs and swarf.

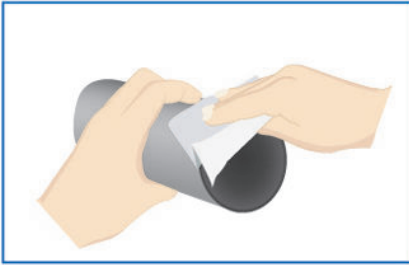

4. Sand lightly. Failure to do so lead to failure of the joint.
5. Clean all dirt, moisture, and grease from pipe and fitting socket, using a clean, dry cloth.

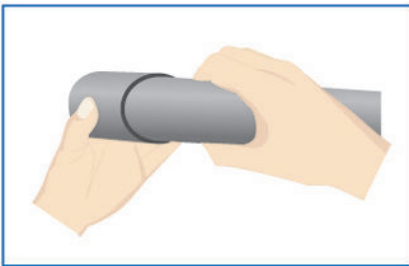

6. Check dry fit of pipe in fitting socket. Pipe should enter fitting socket to between 1/2 and 3/4 the socket depth.

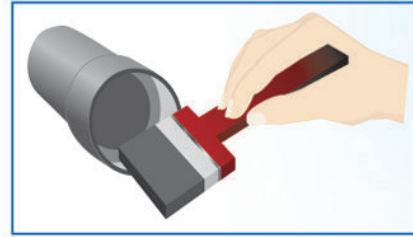

7. Be sure to use only approved types of fittings and adapters
8. Using brush or dauber-type device, apply a light coat of approved solvent cement to the inside of the fitting socket, using straight, outward strikes.

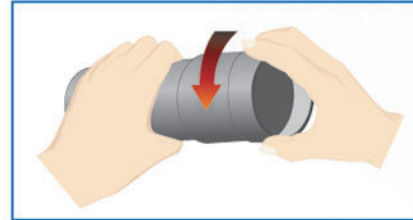

9. Apply solvent cement to the outside of the pipe in a similar manner.
10. Timing is important at this stage: apply cement quickly and do not allow it to set before the joint is put together.
11. Always follow safe-handling practices when using solvent cements: use in a well-ventilated area, avoid skin contact (wear gloves) and do not use near heat, sparks or open flame.
12. Immediately insert pipe into fitting socket, giving the pipe a one-quarter turn and making sure it goes all the way to the socket bottom

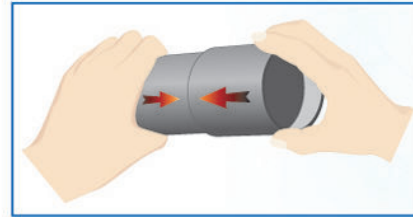

13. Hold the joint together until a tight set is attained

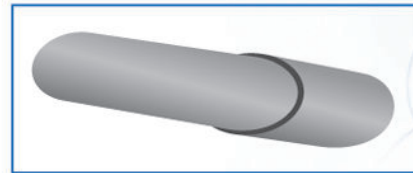

14. Check cement bead around joint. A proper joint will normally show a bead around its entire perimeter.

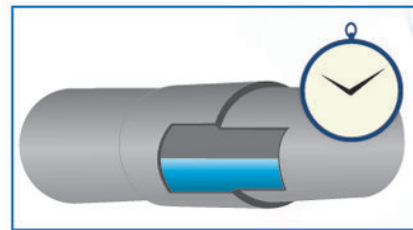

15. Any gaps may indicate insufficient cement or the use of light bodied cement on larger diameters where heavy bodied cement was required.
16. After setting, wipe excess cement from the pipe.
17. Don't move the system until the joints have cured (set) at least as long as recommended by the solvent manufacturer.



**ANSON EXACT CORPORATION (M) SDN BHD (654633-W)**

**Address** : Lot 19089, Jalan Tanming Jaya 1, Taman Tanming Jaya, 43300 Balakong,  
Selangor Darul Ehsan, Malaysia.

**Tel** : + 603-8961 1999 (Hunting line)

**Fax** : + 603-8961 1000

**E-mail** : [enquiry@ansonexact.com](mailto:enquiry@ansonexact.com)

**Website** : [www.ansonexact.com](http://www.ansonexact.com)